



CHENNAI PORT TRUST

**No. 1 RAJAJI SALAI
CHENNAI - 600001**

**Quotation for Desilting the drains and removing the
accumulated swept materials / spilled cargo along the
roads and side drains by using JCB and transporting the
de-silt earth/debris in south zone**

QUOTATION NOTICE NO.Q/WMA6 /1218/2017/E

**CHIEF ENGINEER
Civil Engineering Department**

NIQ FOR WEB



CHENNAI PORT TRUST
CIVIL ENGINEERING DEPARTMENT
No.1 Rajaji Salai,
Chennai – 600001

Sealed quotations are invited from **the GST registered tenderers who are** satisfying the eligibility criteria for the work of **“Quotation for Desilting the drains and removing the accumulated swept materials / spilled cargo along the roads and side drains by using JCB and transporting the de-silt earth/debris in south zone”** as per details furnished hereunder.

Estimated Cost Rs. 1,38,700/-

EMD: Rs. 2800/-

Completion period: 60 days

Minimum Qualification Criteria:

- (i) Average Annual turnover during the last 3 years (as on 31st March 2017) should be atleast 30% of the estimated cost. i.e., Rs. 0.42 lakhs
- (ii) Should have successfully completed similar works during last 7 years (as on 31.10.2017).
 - a) Three similar completed works each costing not less than 40% of the estimated cost i.e. Rs. 0.55 lakhs (or)
 - b) Two similar completed works each costing not less than 50% of the estimated cost i.e. Rs. 0.69 lakhs (or)
 - c) One similar completed work costing not less than 80% of the estimated cost i.e. Rs.1.11 lakhs and

Note : Similar works means “Any Civil Engineering works”

Documentary proof such as work order and completion certificate for experience and audited balance sheet, profit & loss account statement for annual turnover for meeting all the eligibility criteria shall be enclosed with the quotation in original or copies. If the bidder has executed the work for private firms or as a sub contract, the TDS certificate for the particular year along with the above documents shall be submitted. The bids of those firms who do not meet the eligibility criteria shall be treated as invalid and summarily be rejected.

GST Registered tenderers are only eligible to participate in this quotation. Quotation documents can be downloaded from Chennai Port Trust website: www.chennaiport.gov.in. The Demand Draft towards EMD should be submitted with the quotation document. The original demand draft should be reached ChPT before opening the bid. Non submission of DD instrument in original to ChPT may lead to disqualification of bids.

Note: The exemption certificate from NSIC/MSME is applicable for exemption from payment of EMD

Sale period : **03.11.17 to 16.11.17** (on all working days)

Last date for
Submission **1500 hrs on 16.11.17**

Date of opening of
Quotation **1530 hrs on 16.11.17**

For further details, please see the quotation document
Quotation No.Q/WMA6/ 1218 /2017/E.

CHIEF ENGINEER

Visit our web site WWW.Chennaiport.gov.in

CHENNAI PORT TRUST

Quotation for Desilting the drains and removing the accumulated swept materials / spilled cargo along the roads and side drains by using JCB and transporting the de-silt earth/debris in south zone

	Page No.
1. GENERAL RULES AND DIRECTION FOR GUIDANCE	4
2. SCHEDULE 'A' - (Schedule of approximate quantities and rates)	8
3. SCHEDULE 'B' - SPECIAL CONDITIONS	12
4. SCHEDULE 'C' - GENERAL CONDITIONS	15
5. ANNEXURE – I	18
6. ANNEXURE – II	21
7. Drawing	22

CHENNAI PORT TRUST

Quotation for Desilting the drains and removing the accumulated swept materials / spilled cargo along the roads and side drains by using JCB and transporting the de-silt earth/debris in south zone

General Rules and Directions for Guidance

1. Deadline for submission of Quotation:

Quotation must reach the Executive Engineer (MDO), 3rd Floor Old Administrative Office Building, Chennai Port Trust, Rajaji Salai, Chennai – 600 001 at 1500 Hrs. on **16.11.17**.

2. Quotation Prices

2.1 Unless stated otherwise in the Quotation documents, the contract shall be for the whole works as described in NIQ based on the unit rates and prices quoted by the tenderer in Bill of quantities.

2.2 Items against which no rate or price is entered by the tenderer will not be paid for and when executed, such items shall be deemed to have been covered by the other rates and prices in the Bill of quantities. In case, the tenderer not accepted to carryout the items for which rates not-quoted within the quoted price, the offer submitted by the firm will be treated as rejected and the EMD amount paid by the tenderer will be forfeited.

2.3 The amount quoted by the tenderer in the Bill of quantities shall allow for all costs including labour, materials, equipment, transport charges, tests, etc. payable.

3. Validity of Quotation

Quotation shall remain valid for a period **60 days** from the date of opening.

4. Eligible Tenderers

The quotation is invited from the contractors who fulfill the eligibility criteria furnished hereunder:

- (i) Average Annual turnover during the last 3 years ending on 31st March 2017 should be at least 30% of the estimated cost i.e., Rs. 0.42 lakhs.

- (ii) Should have successfully completed similar works during the last 7 years ending 31st October 2017 as follows.
- a) Three similar completed works each costing not less than 40% of the estimated cost i.e. Rs. 0.55 lakhs (or)
 - b) Two similar completed works each costing not less than 50% of the estimated cost i.e. Rs. 0.69 lakhs (or)
 - c) One similar completed work costing not less than 80% of the estimated cost i.e. Rs. 1.11 lakhs and

Note : Similar work means “Any civil Engineering works”

Documentary proof such as work order and completion certificate for experience and audited balance sheet, profit & loss account statement for annual turnover for meeting all the eligibility criteria shall be enclosed with the tender in original or copies. If the bidder has executed the work for private firms or as a sub contract, the TDS certificate for the particular year along with above mentioned documents shall be submitted. The successful bidder should produce original documents for verification by the Chief Engineer or his representative at the stage of Evaluation or as and when required before finalizing the tender. The bids of those firms who do not meet the eligibility criteria shall be treated as invalid and summarily be rejected.

5. Earnest Money Deposit (EMD)

- 5.1 Each Quotation should be accompanied by an Earnest Money Deposit (EMD) amounting to Rs. **2,800/- (Rupees two thousand eight hundred only)** which shall be in the form of Account payee Demand Draft / Banker's Cheque in single instrument can be accepted from any of the Commercial Banks drawn in favour of Chairman, Chennai Port Trust payable at Chennai.
- 5.2 The Account payee Demand Draft / Banker's Cheque shall be enclosed with the Quotation and should not be sent separately.

- 5.3 Under no circumstances should currency note be enclosed in the cover containing the Quotation as Earnest Money.
- 5.4 No other form of deposit towards Earnest Money shall be accepted.
- 5.5 Quotation not accompanied by the Earnest Money Deposit in the manner prescribed by the Trust will be summarily rejected.

However Small Scale Units registered with the National Small Bid Security (also known as Earnest Money) is to be obtained from the bidders except Micro and Small Enterprises (MSEs) as defined in MSE Procurement Policy issued by Department of Micro, Small and Medium Enterprises (MSME) or is registered with the Central Purchase Organization or the concerned Ministry or Department. The bidders should be asked to furnish bid security along with their bids

However no exemption from payment of Security Deposit amount will be allowed in respect of Small Scale Units registered with National Small Industries Corporation Ltd.,

“NOTE: To claim under **Clause 5.5** above, the tenderers are required to produce an attested copy of the NSIC registration Certificate. The attestation should be from a Gazetted Officer of Central /State Government. The exemption from the payment of EMD will be allowed only if the Quotation item of work / supply is covered in the enlistment statement attached to the NSIC certificate. No claims for exemption without the details stipulated above will be considered. The exemption certificate from NSIC/ MSME/ any other organizations is eligible for exemption of EMD only.

6. Opening of Quotation

Quotation will be opened at the office of the **Executive Engineer (MDO) 3rd Floor of Old Administrative Office Building, Chennai Port Trust, Rajaji Salai, Chennai – 600 001 at 1530 Hrs. on 16.11.17.**

7. Refund of EMD

- 7.1 The EMD or Bid securities of the unsuccessful bidders should be returned to them at the earliest after expiry of the final bid validity and latest on or before the 30th day after the award of the contract.
- 7.2 The EMD of the successful tenderer will be refunded only after the remittance of security deposit in any manner as aforesaid. Alternatively, the successful tenderer shall when his tender is accepted, furnish security as specified in the **clause 8 of Schedule B - Special conditions** after giving credit to the amount deposited by him as earnest money. The earnest money shall retain its character, as such, till the successful tenderer furnishes the security deposit.

8. TAXES.

- (i) The firm shall furnish the tax invoice as per GST Act / Rules in the name of Chennai Port Trust by mentioning the GSTIN of ChPT and indicating amounts of GST separately. The GSTIN of Chennai Port Trust is 33AAALC0025B1Z9.
- (ii) The firm shall remit the GST amount in the invoice to the Government within the due dates and also file the returns by mentioning the GSTIN of ChPT to enable ChPT to avail applicable input tax credit.
- (iii) Chennai Port Trust shall reimburse the GST component mentioned in the Invoice to the Contractor / Supplier / Vendor only to the extent and on reflection of the same under the GSTIN of ChPT in the GST web portal.
- (iv) Applicable statutory recoveries including TDS under Income Tax, TDS under GST, etc., will be deducted / recovered while accounting for or making payments to the Contractor / Supplier / Vendor as per the applicable laws.

CHENNAI PORT TRUST

**Quotation for Desilting the drains and removing the accumulated swept materials / spilled cargo along the roads and side drains by using JCB and transporting the de-silt earth/debris in south zone
SCHEDULE 'A'**

(Schedule of approximate quantities and rates)

(1)	(2)	(3)	(4)	(5)	(6)
Sl. No.	Probable Quantity	Description of work	Rate in Figures and in Words Rs. P.	Unit in Figures and in Words	Total Amount Rs. P.
1	75 Hours	Hire charges for engaging of J C B for Digging, loosening and removing the deposited earth mixed with bulk cargos boulders, rubbish etc., to clean the deposited silt inside the drain and removing the silt and other obstruction in side of the drains and in the other lead drains /yards / open places etc. and removing the breaching of accumulated sea sand in the culvert mouth at coastal road and wherever required in south zone by engaging earth mover JCB stacking the removed materials near the accessible area for transporting the same and all as directed at site of work including the equipments hire charges,		1Hour (One Hour)	

(1)	(2)	(3)	(4)	(5)	(6)
		<p>labour, transport, fuel, tools, tackles, etc., complete.</p> <p>Note:</p> <p>1.Payment will be made only for the actual time of work done by Earth mover (JCB) without taking into account the breakdown time and mobilizing / demobilizing hours and idling time.</p> <p>2.The time chart for every day of work shall be maintained jointly by department and contractor.</p> <p>3. JCB should be made readily available whenever required by department during the contract period.</p>			
2		<p>Loading, transporting, dumping and leveling the Surplus earth / swept material/ desilted materials available in the road and drain sides and wherever required in the low lying area in the south zone within a lead of 4 kms as directed all details as per relevant specifications and including all labour transport tools, equipment fuel, etc, complete.</p> <p>Note:</p> <p>1.The tenderer shall maintain trip</p>			

(1)	(2)	(3)	(4)	(5)	(6)
		sheet in triplicate in trust approved format at his own cost for the quantity of surplus earth / debris transported 2. Payment will be made based on lorry measurements. 3. 20% voids shall be deducted from the lorry cubical content for payment for surplus earth / swept materials 4. No deduction of voids for debris will be made			
A	200.00M ³	Surplus earth / desilted materials		1M ³ (One cubic metre)	
B	40.00 M ³	Debris		1M ³ (One cubic metre)	

(Rupees ----- Only)

General Notes

1. The contractor is advised to **inspect the site before quoting the rates.**
2. The rates quoted by the tenderer should be inclusive of all GST, levies, duties and other charges:
 - (i)The firm shall furnish the tax invoice as per GST Act / Rules in the name of Chennai Port Trust by mentioning the GSTIN of ChPT and indicating amounts of GST separately. The GSTIN of Chennai Port Trust is 33AAALC0025B1Z9.
 - (ii)The firm shall remit the GST amount in the invoice to the Government within the due dates and also file the returns by mentioning the GSTIN of ChPT to enable ChPT to avail applicable input tax credit.
 - (iii)Chennai Port Trust shall reimburse the GST component mentioned in the Invoice to the Contractor / Supplier / Vendor

only to the extent and on reflection of the same under the GSTIN of ChPT in the GST web portal.

(iv) Applicable statutory recoveries including TDS under Income Tax, TDS under GST, etc., will be deducted / recovered while accounting for or making payments to the Contractor / Supplier / Vendor as per the applicable laws.

3. The tenderer shall carry out the work as per day to day instruction of the Chief Engineer or his representatives at site.
- 4) The work shall be carried out without any hindrance to the Office Building and normal working conditions of that area.
5. For specification of materials and works Chennai Port Trust Engg. Manual Vol.-I & II and its amended version are to be followed.
6. The contract period is **60 days**
7. The areas should be maintained neat and tidy condition and should always be kept clean to the satisfaction of Chief Engineer or his representatives.
- 8 . For further details EE(C) A may be contacted during office hours **Tel. No. 2531 2328 .**

SIGNATURE OF THE CONTRACTOR

**CHIEF ENGINEER
CHINNAI PORT TRUST**

CHENNAI PORT TRUST

Quotation for Desilting the drains and removing the accumulated swept materials / spilled cargo along the roads and side drains by using JCB and transporting the de-silt earth/debris in south zone

SCHEDULE 'B'

SPECIAL CONDITIONS

1. The work shall be completed within **60 days** from 7th day of placing the order (or) the actual date of starting the work whichever is earlier.

2. CEMENT :

No cement is required for this work.

3. STEEL REQUIRED FOR THE WORK.

No steel is required for this work.

4. SUPPLY OF ELECTRICAL POWER FOR WORKS:

No electrical power supply is required for this work.

5. SUPPLY OF DRINKING WATER AT THE SITE OF WORK:

The Contractor shall make his own arrangements.

6. SUPPLY OF WATER FOR THE WORK:

The Contractor shall be permitted to collect water from the nearest water supply point, free of cost. But the contractor shall make his own arrangements for collection and storage of water required for the work.

7. MISCELLANEOUS CONDITIONS:

- (a) The Chief Engineer shall have the right to omit at his discretion one or more items of work when placing the order.
- (b) The quantities indicated in the schedule are only approximate and can be increased or decreased at the discretion of the Chief Engineer. However, the consequent variation in the total Contract Value will be limited to 20%. The rates quoted shall be firm for such variation. In case the variation results in the total contract value exceeding the prescribed percentage revision of

rates, if any, shall be applicable only for that portion of the contract carried out in excess of the permissible percentage.

8. SECURITY DEPOSIT:

The Contractor shall deposit 5% of the contract value in the form of Demand Draft/ Banker's Cheque drawn on any Scheduled Bank / Nationalized Bank payable at Chennai as Initial Security for the due fulfillment of the conditions of the contract, within 7 days of receiving the order failing which the order shall be cancelled and other arrangements made for executing the work. In addition to the Initial Security 5% shall be recovered from the successive part bills to fulfill the contract. The Security Deposit shall not bear any interest and the Security Deposit shall be forfeited in whole or part at the discretion of the Chief Engineer, if in his opinion the contractor has failed to fulfill any of the conditions of the above contract. The Security Deposit shall be refunded to the contractor along with the bill after the work is completed satisfactorily and certified by the Chief Engineer to that effect.

9. The Contractor should produce Xerox copy of the photo identity card in the form of ration card or voter's list for the Contractor and workers engaged by him to issue Harbour entry pass. The Harbour entry pass can be used along with the Xerox copy of the photo identity issued by Government Authority.
10. The Workers should be in position to produce the Harbour entry pass issued by the trust along with the photo identity card for verification purpose during the work at the port. Also the workers shall not indulge in any other undesirable / objectionable activities like pilferage or stealing the materials from the Port, for which act, the contractor only will be held responsible and the work undertaken by the Contractor will be terminated with immediate effect.
11. The list of persons engaged by the contractor with detailed addresses should be furnished to the Chief Engineer's representative / Executive Engineer concerned and the same will be forwarded to the police station concerned for verification of character and antecedents.

12. Compensation for delay:

If the contractor fails to complete the work in all respects within the time specified or within the extended time that may be allowed by the Engineer, the contractor shall pay or allow to the Board a sum of contract as liquidated and ascertained damages and not by way of penalty, for every day/week or part thereof beyond the said period or extended period as the case may be during which the work shall remain unfinished. Such damages will be deducted from any Amount payable to or to be payable to the contractor including encashment of Bank Guarantee or any Securities/ Guarantees, if any available with the Port Trust. The maximum Amount of Liquidated Damages will be worked out based on the Total Contract value inclusive of all Taxes and Duties thereon.

In case of part / portions of the contract work/ Supply order completed and taken possession by the Trust and the Trust operates/ can be made for operation of the part portion/ supply order, the calculation of Liquidated damages will be restricted to the uncompleted/ undelivered value of the work/ supply order subject to the amount of the maximum percentage prescribed for the Liquidated Damages/ Late Delivery charges of the total value of the contract/supply.

The Liquidated Damages/ Late Delivery charges will be worked out as follows;

i) The Liquidated Damages/ Late Delivery charges whose period of contract / delivery is above four weeks, Liquidated Damages/ Late Delivery charges will be ½% (half percent) per week or part thereof of the total value of the contract subject to a maximum of 5% of the total value of contract.

The payment of such damages does not relieve the contractor of his obligations to complete the works or from any other of his obligations or liabilities under this contract.

CHIEF ENGINEER
CHENNAI PORT TRUST

CHENNAI PORT TRUST

Quotation for Desilting the drains and removing the accumulated swept materials / spilled cargo along the roads and side drains by using JCB and transporting the de-silt earth/debris in south zone

SCHEDULE 'C'

GENERAL CONDITIONS

1. No materials will be supplied free by the Trust and it is the responsibility of the contractor to procure and supply all the materials required for the work at their cost.
2. If any materials issued to the contractor by the Trust for the use on the work is lost or damaged, the cost thereof at the ruling market rate or at the Trust's issue rate whichever is higher plus 20% storage charges in either case will be recovered from any money due or that may become due to the contractor.
3. The quantities given in the schedule of quantities are those upon which the approximate estimated cost of the work is based but they are subject to alterations, omissions, deductions and additions and do not necessarily show the actual quantities of the work to be done.
4. The work shall be done to the satisfaction of the Chief Engineer or his representative.
5. The Chief Engineer may cancel the contract at his option at any time without notice for any reason including poor progress of work. The decision of the Chief Engineer is final and will be binding on the contractor.
6. In case the contractor leaves the work incomplete the Chief Engineer shall have the right to have the work completed through any other agency and recover the extra expenditure incurred by the Trust in so doing from any money due or to become due to the contractor.
7. The Contractor shall conform and comply with the regulations and by-laws of the Chennai Port Trust Board and of all other local authorities such as the Corporation of Chennai. The Chief Electrical Inspector to Government of Tamilnadu, the Tamilnadu Electricity system, the Factories Act, the Government Customs and Police Department, etc. The contractor shall conform to rules, regulations, etc. concerning injury to workman compensation for injury to workmen, Insurance for workman etc. The Contractor shall also conform to contract labour (Regulations and Abolition) Central Rule 1971 etc.

8. The Contractor shall be responsible for any accident; damage for injury caused to any his employees or property or any person or property in course of the work and shall hold the Port Trust blameless in respect thereof any also in respect of any claim made by any person or any reasons whatsoever.
9. The contractor shall be solely responsible for reporting to the Board and Police Department immediately of any serious or fatal accident inside the Trust's premises to any of his employees/workmen engaged by him or any persons involved in an accident at site of work.
10. The work shall be carried out without causing any inconvenience to the Trust and to other works in progress in the neighbourhood and any losses to the Trust.
11. Only vehicles licensed by the Board will be allowed inside the Port premises. Admission into the Harbour is regulated by issue of passes for the contractor and his staff. Entry passes will be issued free of cost to the contractor. The contractor is solely responsible for all the details incorporated in the passes; the Trust is indemnified against their misuse. The entry passes shall be produced at the time of entry and any other time when demanded by the CISF personnel or department officials. Further, in the event of loss of entry passes or identity card issued to the contractor or their labour, Rs.20/- will be imposed as penalty in each case.

Engineering Department shall recommend the contractor/ firms to register with the pass section. Applicants should apply in the prescribed format to get a code number for the firm from the Pass section and should produce authorized signature of two persons per firm who will sign the pass application. Any changes in the Authorized signatories, both of the firm's officials should be intimated to pass section immediately.

Provision for individual and vehicle Harbour Permits are alone available in the Pass Section Module and not for the Materials.

As per ISPS requirements all the Port users should submit antecedent verification / police verification or Pass port copy of their employees / contract workers, since it is a pre- requisite for issuing all Port Entry passes.
12. Only vehicles licensed by the Board will be allowed to ply inside the harbour. Private carts of any kind are not permitted within the harbour area.
13. The work shall be carried out only during Trust's working days between 7.30 A.M. and 5.00 P.M.
14. The quantities of work executed will be measured and payment made once a month generally except in the case of work for which the time for

completion is specified as six weeks or less than six weeks in which case payment will be made once only on satisfactory completion of the work.

15. It shall be clearly understood that the rates mentioned in the schedules are inclusive of everything required to be done for the proper completion of the work.
16. Measurements shall be taken jointly by the Engineer-in-charge or his authorised representative on the one hand and by the contractor or their representative on the other. Before taking measurements of any work, the Engineer-in-charge or the person deputed by him for the purpose shall give a reasonable notice to the contractor. If the contractor fails to attend or send an authorised representative for measurement after such a notice or fails to countersign or to record the objection within a week from the date of measurements, then in any such event, measurements taken by the Engineer-in-charge or by the person deputed by him shall be taken to be the correct measurement of the work.
The contractor shall, without extra charge, provide assistance with every appliance and other things necessary for measurement. Measurements shall be signed and dated by both parties each day on the site on completion of measurement. If the contractor objects to any of the measurements recorded on behalf of the Employer, a note to that effect shall be made in the measurement book against the item objected to and such note shall be signed and dated by both parties engaged in taking the measurements.
17. All payments made by the Trust to the contractor for the work shall be rounded off to the nearest rupee.
18. The work shall be completed within **60days** from the 7th day of placing the order or actual date of starting the work whichever is earlier.
19. If the progress of work is held up owing to circumstances which in the opinion of the Chief Engineer are beyond the control of the Contractor, Such as War, stormy weather and other reasonable causes, the Chief Engineer may at his discretion, grant to the Contractor such extension of time as he considers reasonable for the completion of the work. The grant of such extension of time will not bestow on them any claim for compensation or extra payment at a future date whatsoever.

**CHIEF ENGINEER
CHENNAI PORT TRUST**

CHENNAI PORT TRUST
CIVIL ENGINEERING DEPARTMENT
ANNEXURE I

The clauses related to Implementation of ESI Act, 1948 is furnished below:

- (a) As per the Govt Notification dt 20.7.09, Chennai Port Trust has registered under the ESI Act on 26.09.2012 with ESI Corporation and provision of ESI Act, 1948 are applicable to Chennai Port Trust, a Social Security Act, is applicable to Factories using power and employing 10 or more personnel and establishment employing 20 or more persons and drawing wages/Salary upto Rs. 21,000/- per month. Workers covered under ESI Act, are entitled for full medical care for self and family. Besides, cash benefit in the event of sickness, maternity and employment injury. Accordingly, the contractual/casual employees drawing wages upto Rs.21,000/- per month employed either directly by Port Trust or through contractor are covered under ESI Act, 1948. It is obligatory on the part of the employer to calculate and remit ESI contribution comprising of employers' share of 4.75% plus employees' share of 1.75% which is payable on or before 21st of the following month, to which the salary relates.
- (b) In case of Contractor employs more than 20 employees, they should register their name with ESI as per ESI Act, 1948 and obtain ESI Code. Both Employers share of 4.75% and Employees contribution of 1.75% (recovered from employees), totally 6.5% to be paid as contribution to ESI in their Code on or before 21st of following month to which the salary relates and acknowledgement for the same shall be submitted to the Port while claiming the bill. The bill without the acknowledgment of ESI contribution will not be entertained. In case the contractor has not paid the ESI contribution same will be recovered in the running bill and paid to the ESI Corporation in contractor's code. The delay in payment of contribution payable under the Act may be recovered as an arrear of Land Revenue.
- (c) In case the contractor employs less than 20 employees, the list of employees' names, their father's name, identification proof, one passport photo shall be submitted to the Port Trust. The contribution of ESI amount, both Employers share of 4.75% and Employees of 1.75% (recovered from Employees salary), totally 6.5% shall be paid by the contractor in the Chennai Port Trust Code on or before 21st of the following month to which the salary relates or otherwise payment to the contractor will be withheld. If the contractor fails to comply with the above instruction, then the Principal Employer (Chennai Port Trust) will make payment to the

ESI Corporation. Such amount will be deducted from any amount due to the contractor. The delay in payment of contribution payable under the Act may be recovered as an arrear of Land Revenue.

- (d) As per the above Government Notification
- i) All intending tenderer at the time of tender shall disclose all necessary documents as to whether they are covered under ESI Act or not.
 - ii) In case they are covered under ESI Act, they have to furnish the details of registration.
 - iii) In case the tenderer does not possess ESI Registration at the time of Participation in the Tender, then they should obtain registration under ESI Regulations before award of the work by Chennai Port Trust and submit the same within 30 days from the date of issue of work order. Any payment towards the work order will be made only after compliance of the ESI Regulation.
 - iv) The tenderer shall submit his first bill together with evidence of having obtained registration under ESI Regulations and only then the bill will be processed for payment. Subsequently, the tenderer should periodically submit to Chennai Port the Form 6 prescribed under ESI Regulations along with the proof for having remitted the dues under ESI Regulations in respect of the workers/labours employed for the work awarded by Chennai Port to facilitate making payment for the bills of the contractor.
 - v) In case the tenderer are not covered under ESI Act, or exempted, they would furnish necessary documents along with an affidavit in original affirming before a first class Judicial Magistrate in a Non-Judicial Stamp paper worth Rs. 20/- to that effect.
 - vi) In case they are not covered under ESI Act, they must additionally indemnify ChPT against all damages & accident occurring to his labour in a Non-judicial Stamp Paper worth Rs.100/-.

Cess

Payment of Cess in Tamilnadu Construction Workers Welfare Board towards Building Or other construction works undertaken by the Port Tamil Nadu Construction Workers Welfare Board has raised the demand to remit the Cess at 1% of the total estimate cost of the building or other construction works undertaken by Chennai Port Trust towards the benefit of the manual workers in the employment in construction or maintenance of dam, bridges, roads or in any building operations.

Based on the above, Board's approval has been obtained vide BR No.122, Dated 21.08.15 for the following:

- 1) Consider the payment of cess to TNCWWB at 1% of the building or Other construction works undertaken by Chennai Port Trust as per the provisions of the Tamil Nadu Manual Works (Regulation of employment and conditions of work)

Act, 1982 and Tamil Nadu Manual Workers (construction Workers) Welfare Schemes, 1994 and G.O. (MS) No.295, Dt 17.12.2013:of Labour and Employment(12)Department

- 2) Effect the payment of cess to TNCWWB prospectively for the works for which 'NIT' issued after the date of approval for the subject proposal;
- 3) Add the component to that effect in the estimate proposed for the building or other construction works (involving civil Engineering Contractors) at the rate of 1% in each item at the end of analysis of rate after adding water charges and contractor's profit and overhead charges for civil works involving building and other constructions works only. In case, no such provision is made in the estimate and value put to tender the 1% cess will be borne by CHPT and contribution will be made directly to TNCWWB.
- 4) Recover @ 1% of the billed amount progressively from each running bill as well as the final bill of the contractor for the works which are covered under Cess act and remit/deposit the same to TNCWWB through the Finance Department, and wherever, such provision is not available in estimate or tendered amount of ongoing contract, the 1% cess will be borne by the Trust.

In this regard, hitherto the following procedure shall be adopted:

1. A provision, for Tamil Nadu Construction Workers Welfare Cess @ 1% in each item at the end of analysis of rate after adding water charges and contractor's profit and overhead charges shall be added in the estimate prepared for civil works involving building and other constructions works
2. A recovery @ 1% of the billed amount shall be effected progressively from each running bill as well as the final bill of the contractor for the works which are covered under cess act and remit/deposit the same to TNCWWB through the Finance Department.
3. In the case of ongoing contract for building or other construction works which have been amended on or after Board's resolution, where no provision has been made towards recovery of Tamil Nadu Construction Workers Welfare Cess @ 1%, Chennai Port Trust will borne the contribution towards Cess @ 1% of the billed amount progressively from each running bill as well as the final bill of the contractor for the works which are covered under Cess act and remit/deposit the same to Tamil Nadu Construction Workers Welfare Board.

Chief Engineer
Chennai Port Trust

**CHENNAI PORT TRUST
ANNEXURE-II**

As required under the GST Act, Chennai Port Trust has obtained **GSTIN Provisional ID No. 33AAALC0025B1Z9**, All the venders of CHPT including contractors, suppliers, consultants and other service providers shall furnish the GSTIN ID of CHPT in the invoices/ bills raised on CHPT with effect from 01.07.17. The tenderer shall furnish the following details along with a photocopy of the registered GSTIN No. while submitting the quotation document.

S.No	GSTIN Details	Data to be filled up
1	Name of the Firm	
2	Type of Vender whether registered under GSTIN or not	Supplier of Goods/ Supplier of service/ Both (Tick relevant)
3.	Whether registered under	YES/ NO
4	Name & Address as registered in GSTIN	
5	GSTIN No. [copy should enclose]	
6	State of registration of GSTIN	
7	Status of GSTIN Registered customer whether SEZ/ EOU/DTA/ Govt/ Local Authority	
8	PAN No [copy should enclose] *	
9	Mobile No/ Fax No.	
10	e-mail id	
11	Contact person	
12.	Contact Landline NO.	

Seal and Signature

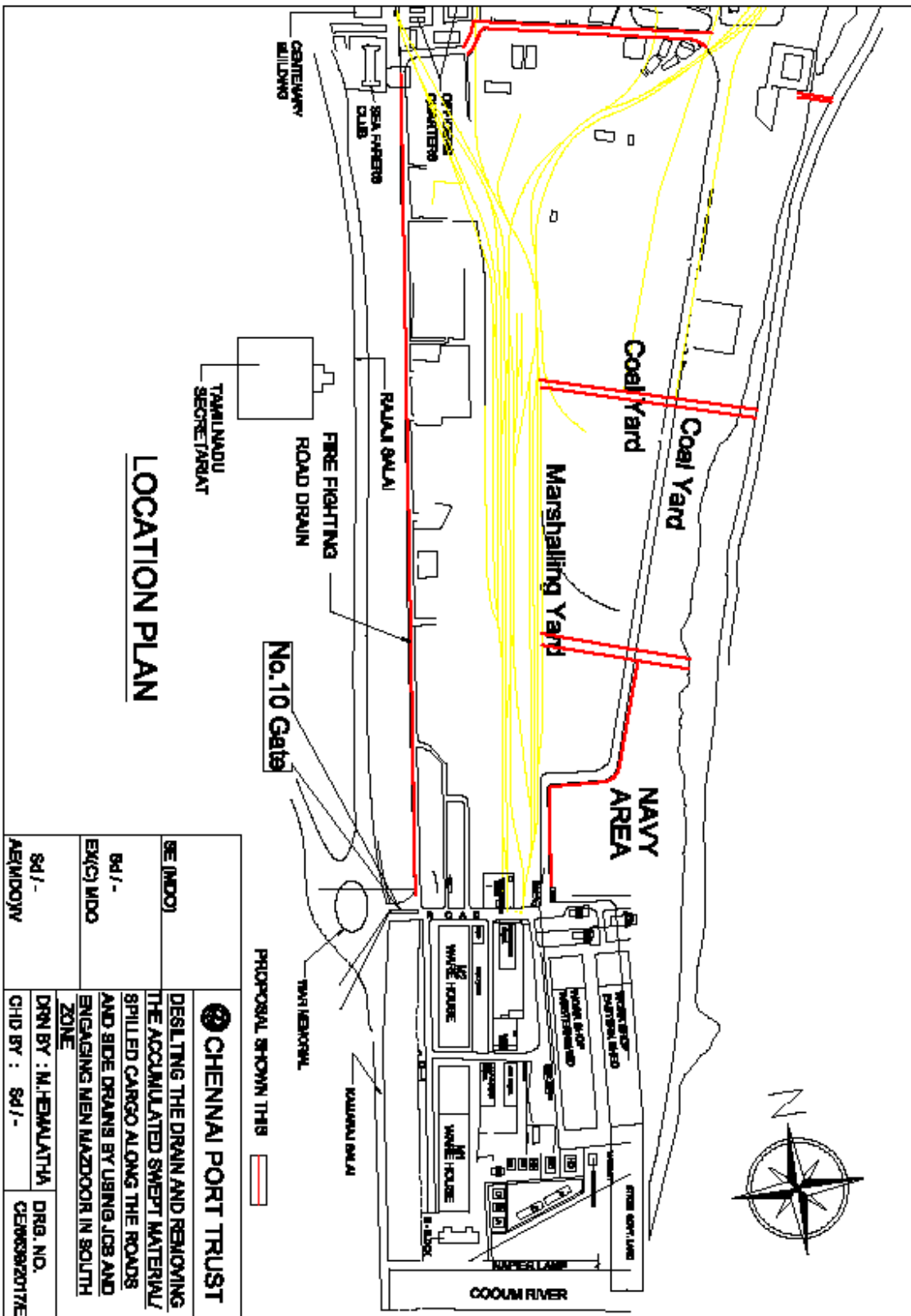

LOCATION PLAN

BE (INDO)	CHENNAI PORT TRUST		
SA/- EXC/MDO	DESIGNING THE DRAIN AND REMOVING THE ACCUMULATED SWEEP MATERIAL/ SPILLED CARGO ALONG THE ROADS AND SIDE DRAINS BY USING JOB AND ENGAGING MEN MAZDOOR IN SOUTH ZONE		
SA/- A/INDO/M	DRN BY : M.HEMALATHA	DRG. NO.	CE/MS/2017/16
CHD BY : SA/-			